	MODEL NUMBER: PD168-059 Dual Monitor Mount	Document Number: PD196-399R2
	Installation Instructions	Page 1 of 6

INTRODUCTION

This document provides the information to assemble and install a PD168-059 Dual Monitor Mount provided by PDi Communication Systems. These instructions cover the standard design of the pendant mount and any customizations that have been included may not be specifically outlined in these instructions.

SAFETY

1. Always wear safety glasses/goggles to prevent injury from debris.
2. Follow the installation/removal instructions for your existing products.

TOOLS REQUIRED

1. Phillips screwdriver
2. 3/16" and 7/16" hex wrenches
3. Safety glasses/goggles

INSTALLATION

Included Hardware:

- 8 each; **PDIPPHMSM4X710** – Screw, M4 x 10mm Long, Phillips Pan Head

1. Unpack the P19A TV (sold separately) and place on workbench face down. If necessary, place protective mat on workbench to ensure the viewing surface is not damaged.
2. Place the 15.6" Teguar Tablet (not provided by PDi) facedown next to the P19A TV so that it is on the right as shown in Figure 1.

FIGURE 1. MONITOR ARRANGEMENT

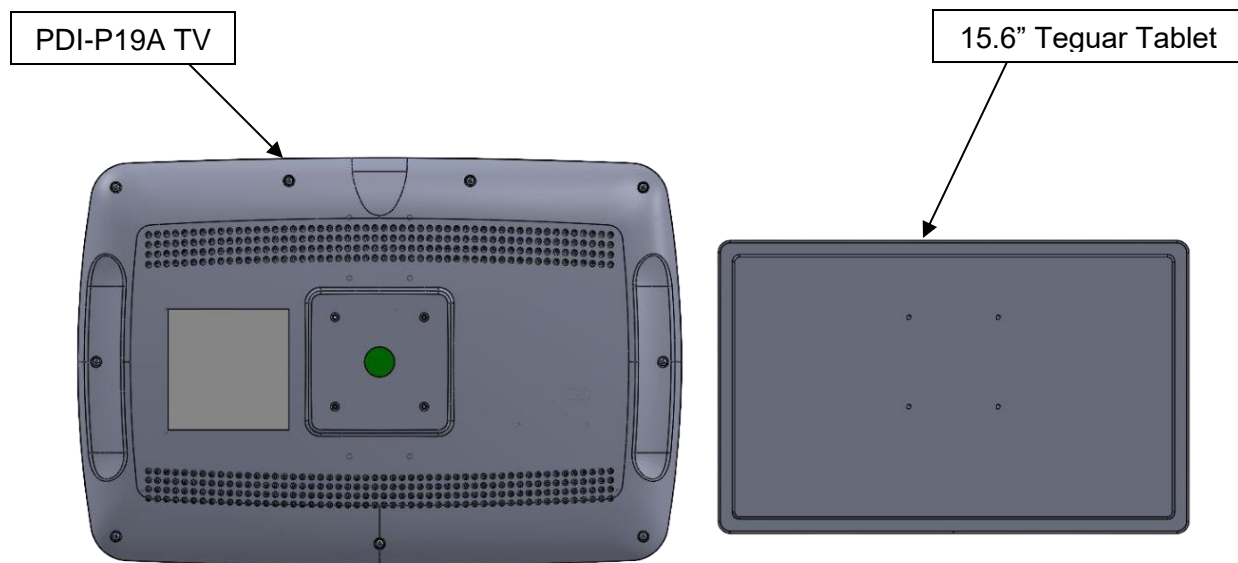

BOTTOM OF MONITORS

- Remove the cover from the Dual Mount Arm as shown in Figure 2. Do not discard any of the parts, as they will be needed later.

FIGURE 2. DUAL MOUNT ARM

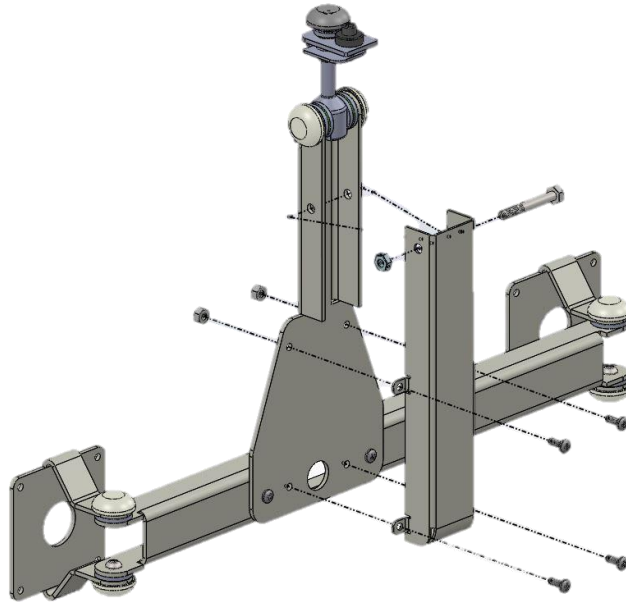

- With the Dual Mount Arm oriented as shown in Figure 3, feed the cables from the P19A and the tablet through the 1.25" hole in the VESA mounting bracket for each monitor.

FIGURE 3. CONNECTING THE DUAL MOUNT ARM

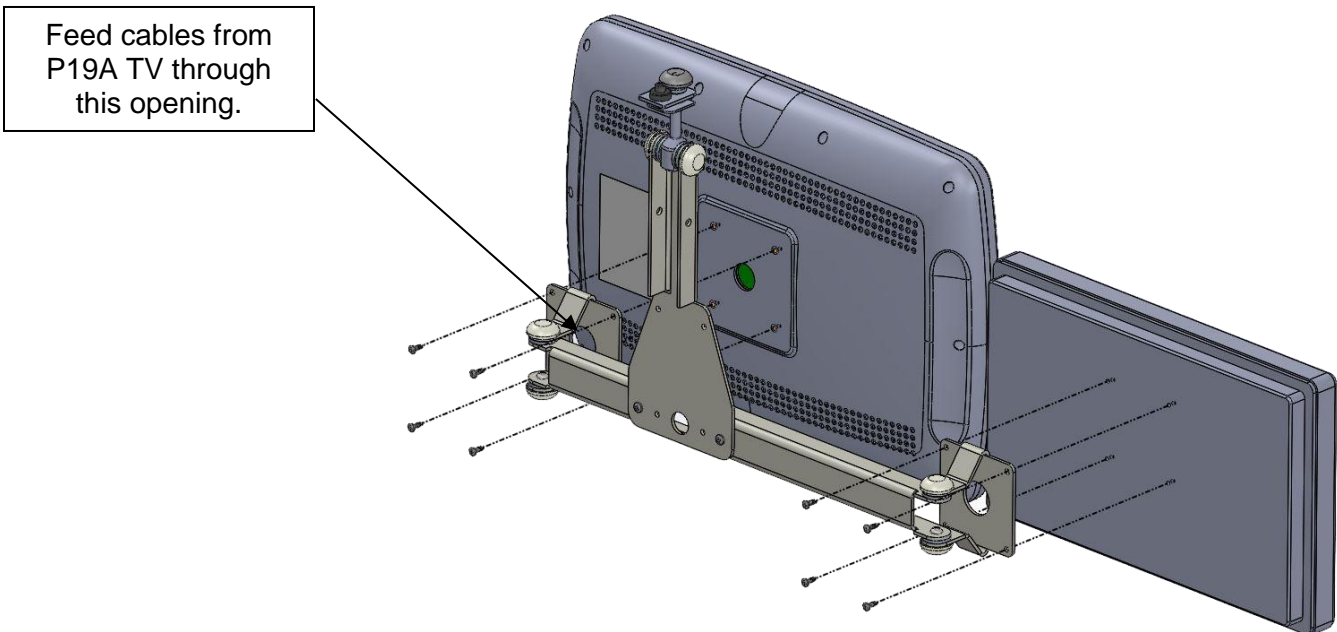

	MODEL NUMBER: PD168-059 Dual Monitor Mount	Document Number: PD196-399R2
	Installation Instructions	Page 3 of 6

- Place the Dual Mount Arm on the back of each monitor and connect the monitors with the M4 screws, **PDIPPHMSM4X710** (4 per monitor; see Figure 4).

FIGURE 4. SCREW INSTALLATION AND CABLE ROUTING

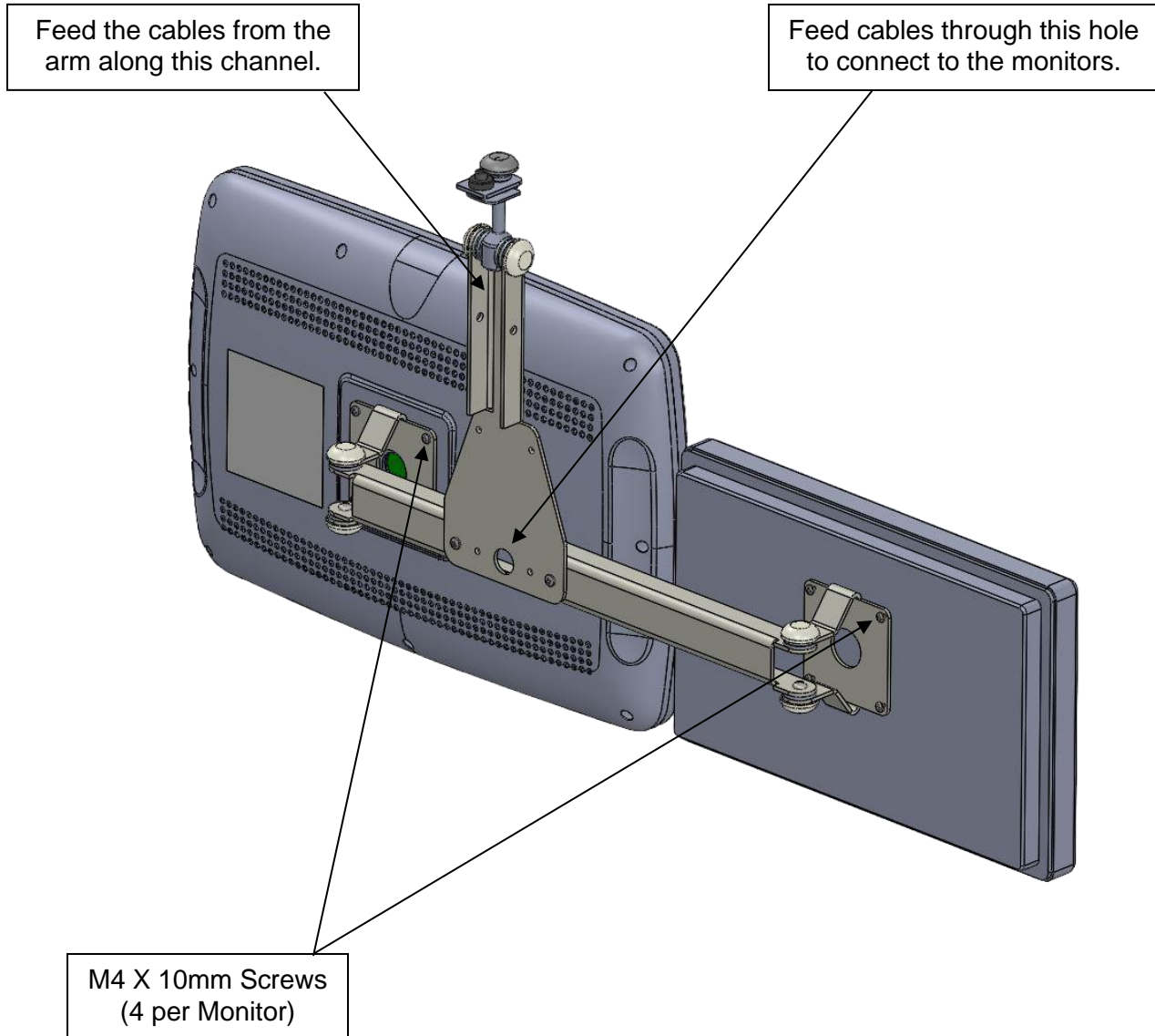

- Attach the Dual Mount Arm to the nose of the PDI arm using the socket head cap screw, **PD209-002**, and lock washer, **PDISLW25**, from the Swivel Assembly in the Dual Mount Arm, as shown in Figures 5A & 5B.

FIGURE 5A. MOUNTING DUAL ARM TO SWING ARM

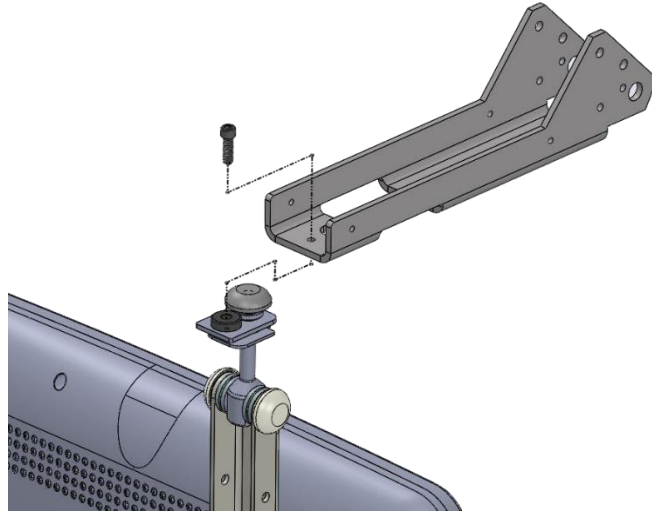
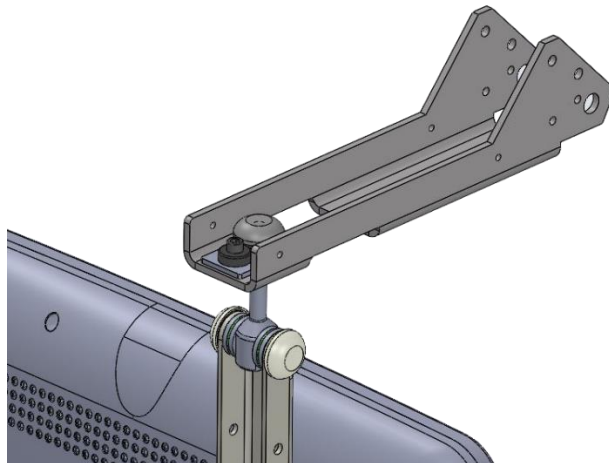



FIGURE 5B. MOUNTING DUAL ARM TO SWING ARM



7. Route cables through the Dual Mount Arm as specified in Figure 4 and connect the devices according to their respective installation documents.
8. Confirm the devices are working properly. Reinstall the cover that was removed in Step 3 (see Figure 2).

	MODEL NUMBER: PD168-059 Dual Monitor Mount	Document Number: PD196-399R2
	Installation Instructions	Page 5 of 6

REVERSING THE SWIVEL MOUNT

If the desired direction the TV is facing changes, follow the steps below to switch the direction.

1. Remove the plastic Cap Plug, **PDI-271**.
2. Using two 7/16" hex wrenches, unscrew the Stover lock nut, **PDISLN2520**, and hex head bolt, **PDIHCS2520200**, as shown in Figure 6A.
 - a. NOTE: The hex head bolt is what holds the lower swivel assembly (swivel stem, brake discs, washers, etc.) together. If not secured, the lower swivel assembly will fall apart and will need to be reassembled before Step 3.

FIGURE 6A. UNSCREWING THE HEX BOLT

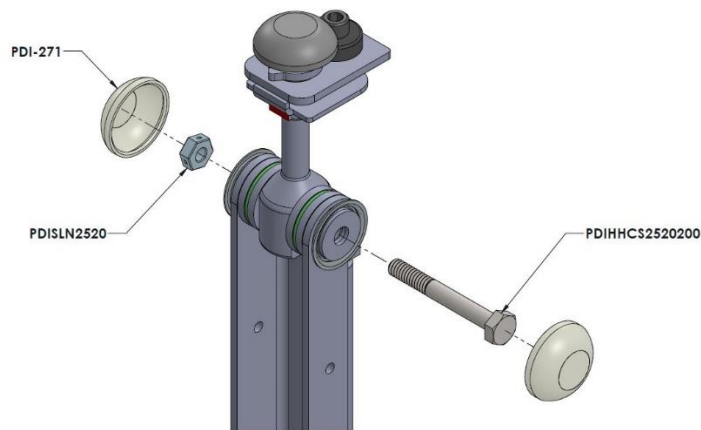

3. Rotate the entire upper swivel assembly one-hundred-eighty degrees. Refer to Figure 6B.

FIGURE 6B. ROTATING THE SWIVEL

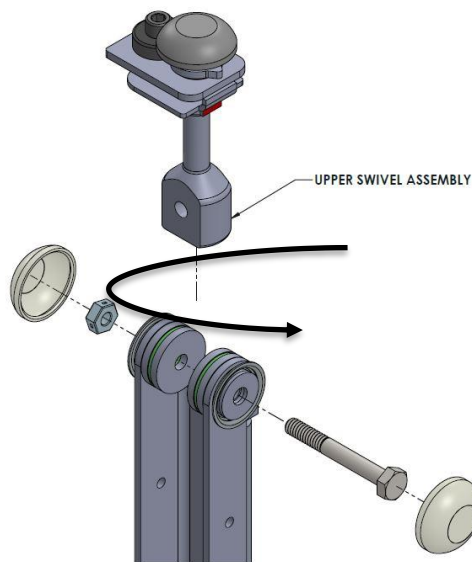

	MODEL NUMBER: PD168-059 Dual Monitor Mount	Document Number: PD196-399R2
	Installation Instructions	Page 6 of 6

4. Realign the upper swivel assembly with the lower swivel assembly. Re-install the hex head bolt and Stover lock nut, tighten to 100in-lbs Torque. Re-assemble the Cap Plugs, as shown in Figure 6C.

FIGURE 6C. REATTACHING THE SWIVEL

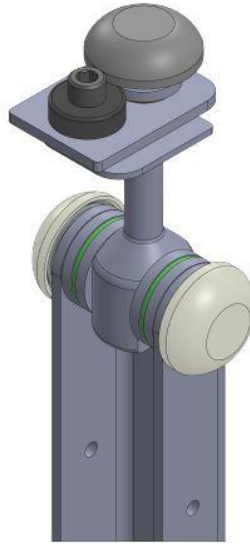

5. If the components in the lower swivel move or their alignment is lost, align the components as shown below to arrange correctly.

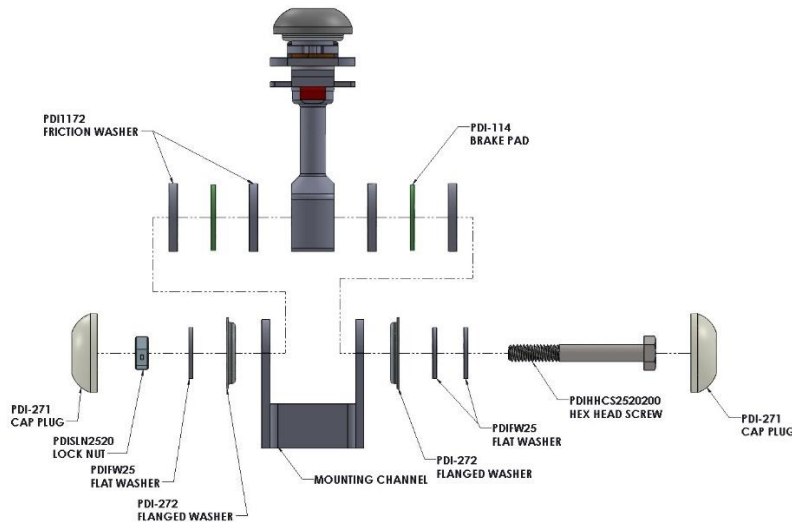

WARRANTY

PDi Communication Systems Inc., (“PDi”) standard warranty information is found at pdiam.com. For information regarding authorized servicing and all other information pertaining to this warranty, please contact PDi COMMUNICATION SYSTEMS, INC. at 40 Greenwood Ln, Springboro, Ohio 45066 or phone 800-628-9870 and ask for the PDi ProServices team.

