	MODEL NUMBER: <b>PDI-LCD-GRID-MT &amp;          PDI-DUAL-GRID-MT</b>	Document Number: PD196-055R10
	LCD Grid Mount Installation Instructions	Page 1 of 3

**Scope:**

A PDi primary LCD TV mount required to attach the TV(s) to this PDI-LCD-GRID-MT or PDI-DUAL-GRID-MT. The primary LCD TV mount must match the VESA mounting pattern of the TV to be mounted. For simplicity, only PDI-LCD-GRID-MT is shown

Note: The maximum capacity for these mounts is 65 pounds.

**Safety Steps:**

1. Always wear safety glasses/goggles to prevent injury from debris.
2. Follow the installation/removal instructions for your existing products.

**Tool List:**

1. P1 or P2, Phillips screwdriver
2. 5/32" Allen wrench
3. 3/16" Allen wrench
4. 7/16" Hex wrench
5. Safety glasses/goggles

**Bill of Materials:**

Item	Part Number	Description	QTY
1	PD122-001	Synthetic Grease	1
2	PD185-001	Rotational Stop Collar	2
3	PD198-003	10 ft. Power Cord	1
4	PD235-002	Loctite, #242 Blue	1
5	PD240-001	Upper Support	1
6	PD240-002	Lower Support	1
7	PD240-003 or PD240-003-DUAL	Mounting Bracket	1
8	PDI-590	Sleeve	2
9	PDIBHSCS252038	1/4-20 x 3/8" Button Head Cap Screw	2 (4 for PDI-DUAL-GRID-MT)
10	PDIBHSCS252050	1/4-20 x 1/2" Button Head Cap Screw	1
11	PDIBHSCS252062	1/4-20 x 5/8" Button Head Cap Screw	1
12	PDINILN2520	1/4-20 Nylock Nut	6
13	PDIPPHMS2520200	1/4-20 x 2" Phillips Pan Head Machine Screw	4
14	PDISHCS252020	1/4-20 x 1/4" Socket Head Cap Screw	1
15	PDISHN2520	1/4-20 Standard Hex Nut	1

**Procedure**

**Mounting Upper Support**

1. Find desired mounting location and remove adjacent tiles for a workspace.
2. Place **PD240-001** Upper Support (#5) on top of the tile, across the 24" dimension, that the assembly will be mounted to and string the required guy-wires but DO NOT attach to the **PD240-001** Upper Support (#1). Verify correct type of guy-wire required per local building code.
3. Determine which of the three (3) sets of mounting holes will be used to provide the best placement for the installation. Cut ONE of the 2-1/2" x 3-3/4" holes out of the tile and drill pilot holes (3/16" diameter) for the four (4) mounting screws.

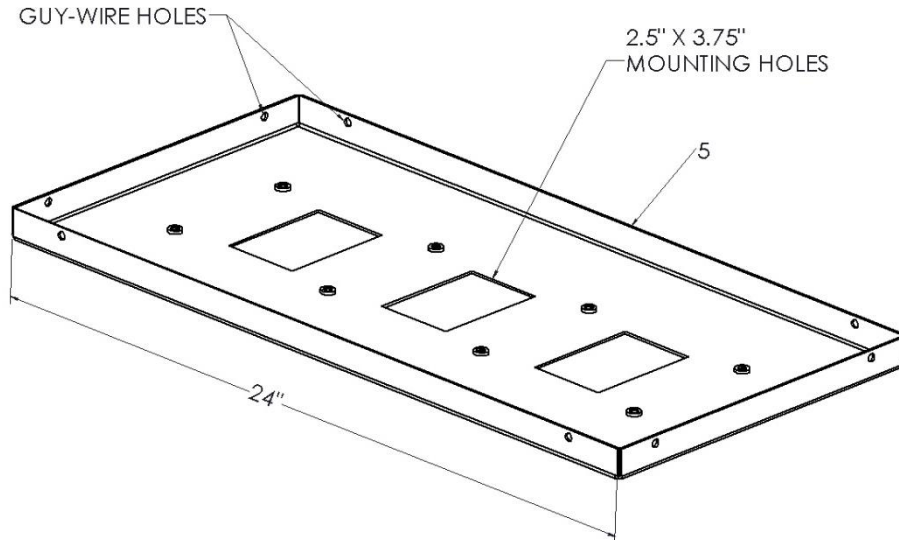

	MODEL NUMBER: <b>PDI-LCD-GRID-MT &amp;          PDI-DUAL-GRID-MT</b>	Document Number: PD196-055R10
	LCD Grid Mount Installation Instructions	Page 2 of 3

### Assembling Lower Support

1. Install one (1) **PDIBHSCS252062** Screw (#11) and one (1) **PDIHN2520** Standard Nut (#15) into the **PD240-002** Lower Support (#6) as shown and securely tighten.
2. Install one (1) **PDINILN2520** Nylock Nut (#12) to the **PDIBHSCS252062** Screw (#11) as shown and securely tighten.
3. Install two (2) **PDI-590** Sleeves (#8) into the **PD240-002** Lower Support (#6) as shown and apply **PD122-001** Synthetic Grease (#1) to surfaces of the **PDI-590** Sleeves (#8).

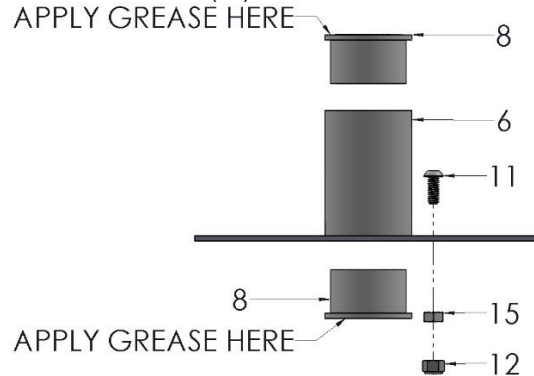

### Assembling Mounting Bracket Assembly

1. Determine the desired mounting height for the LCD.  
**Note:** There must be a minimum of 12" from the **PD240-002** Lower Support (#6) to the bottom of the **PD240-003** or **PD240-003-DUAL** Mounting Bracket (#7). There must also be a minimum of 2" from the top of the upper **PD185-001** Rotational Stop Collar (#2) and the top of the **PD240-003** or **PD240-003-DUAL** Mounting Bracket (#7).
2. Slide one (1) **PD185-001** Stop Collar (#2) over the **PD240-003** or **PD240-003-DUAL** Mounting Bracket (#7) and securely tighten at the desired mounting height.
3. Slide the **PD240-002** Lower Support (#6) onto the **PD240-003** or **PD240-003-DUAL** Mounting Bracket (#7) until it rests on the **PD185-001** Support Collar (#2) and install one (1) **PD185-001** Rotational Stop Collar (#2) on top of the **PD240-002** Lower Support (#6). Securely tighten both **PD185-001** Rotational Stop Collars (#2) at the desired mounting height.  
**Note:** If additional clearance is needed in the ceiling, the **PD240-003** or **PD240-003-DUAL** Mounting Bracket (#7) can be trimmed to no less than 2" above the upper **PD185-001** Rotational Stop Collar (#2). If this is done, drill a new 17/64" hole for the **PDIBHSCS252050** Screw and debur the inside of the tube to prevent damage to the cables.
4. Install one (1) **PDIBHSCS2520** Screw (#10) from the inside of the **PD240-003** or **PD240-003-DUAL** Mounting Bracket (#7) as shown using one (1) **PDINILN2520** (#12). **This is a required safety screw.**
5. Install one (1) **PDISHCS252025** Screw (#14) with **PD235-002** Loctite (#4), into the bottom **PD185-001** Rotational Stop Collar (#2).

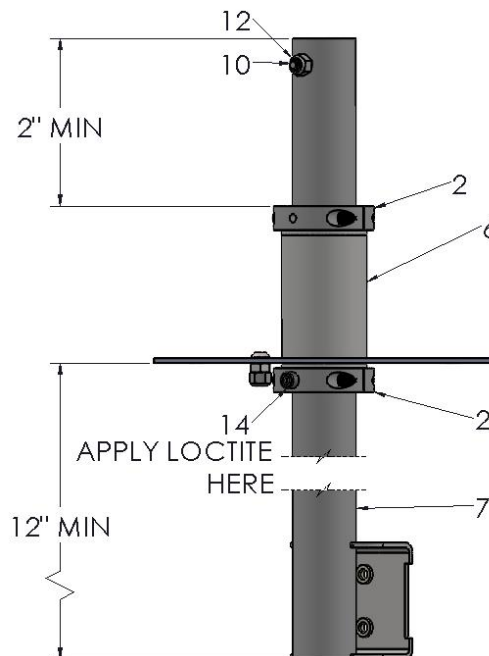

	MODEL NUMBER: <b>PDI-LCD-GRID-MT &amp;          PDI-DUAL-GRID-MT</b>	Document Number: PD196-055R10
	LCD Grid Mount Installation Instructions	Page 3 of 3

### Attach the Mounting Bracket to Ceiling

1. Insert the **PD240-003** or **PD240-003-DUAL** Mounting Bracket (#7) through hole in ceiling tile and attach the **PD240-002** Lower Support (#6) to the **PD240-001** Upper Support (#5) with four (4) **PDIPPHMS2520200** Screws (#13) and four (4) **PDINILN2520** Nylock Nuts (#12). **Be careful to not over tighten the screws and crush the tile.**  
**Note:** There must be a minimum of 12" from the ceiling tile to the bottom of the **PD240-003** or **PD240-003-DUAL** Mounting Bracket (#7).
2. Attach the guy-wires to the **PD240-001** Upper Support (#5).
3. Install the primary LCD TV mount(s) to the **PD240-003** or **PD240-003-DUAL** Mounting Bracket (#7) using two (2) **PDIBHSCS252038** Screws for each primary LCD TV Mount.

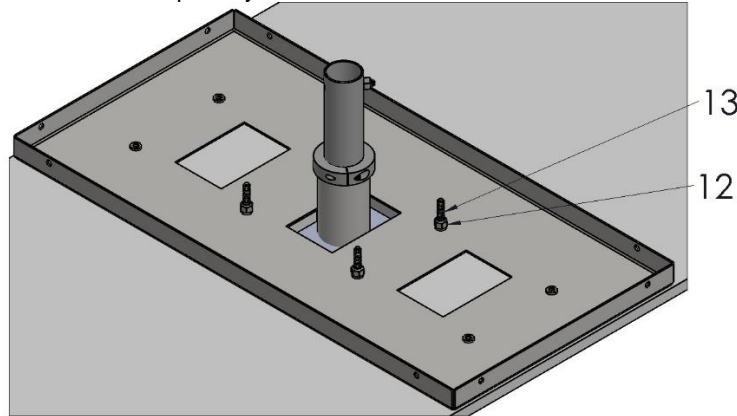

### Optional Attachment of Outlet Electrical Box:

1. Select an appropriately sized single gang "OLD WORK" or "REMODELING" electrical box.
2. Cut only **ONE** of the remaining rectangular holes in the **PD240-001** Upper Support (#5) through the ceiling tile to match the electrical box.
3. Install the electrical box per the manufacturer's instructions. **Be careful not to over tighten the screws and crush the tile.**