

INSTALLATION SHEET

Document Number: PD196-088 Rev 2

INTRODUCTION

The PDI-267 Vertical Stop Kit is designed to provide additional wall clearance for a PDI-508 or PDI-405 support arm when in the folded position. Increased clearance is particularly helpful to allow the arm to be installed beneath a head wall light or other obstruction.

INSTALLATION

1. With the arm installed in the wall bracket, pull the arm forward away from the wall to expose the Stop Bolt Hole.
2. Thread a Nylon Spacer onto the stop bolt. Fit the bolt into the Stop Bolt Hole.
3. Fit the remaining Nylon Spacer onto the bolt end and secure with the Stover Nut provided.
4. Cycle the arm and verify correct operation and improved wall clearance.

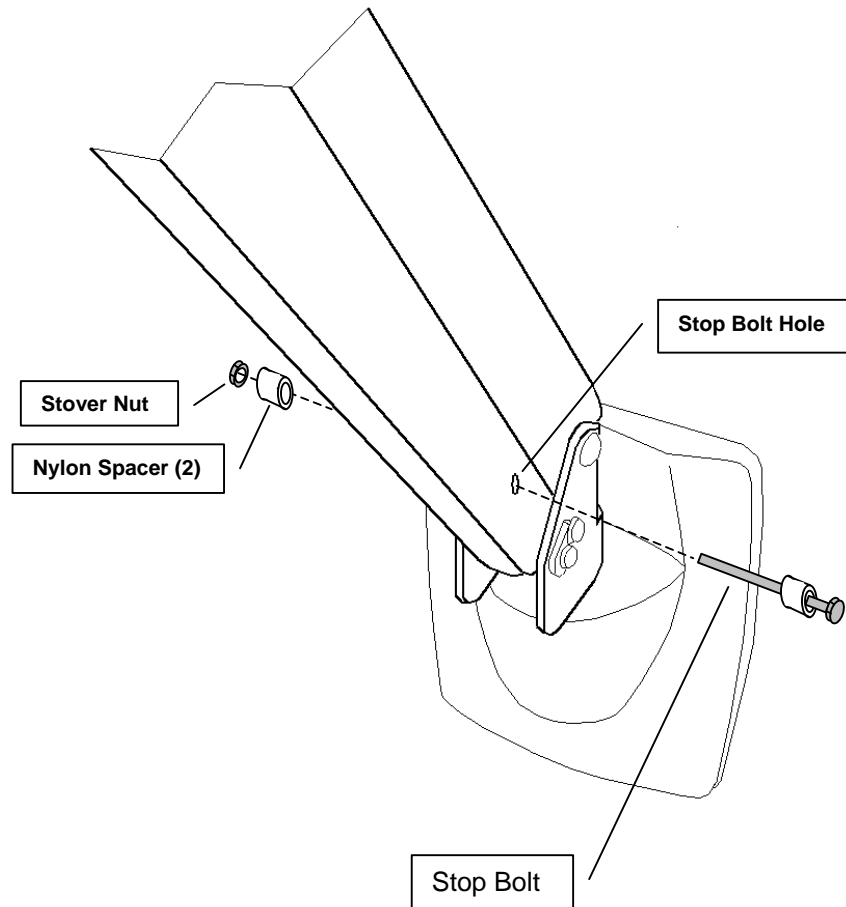

NOTE: Larger diameter nylon spacers are available to provide increased wall clearance. Please refer to Page 2 of this instruction sheet for details.

INSTALLATION SHEET

Document Number: PD196-088 Rev 2

ORDERING INFORMATION

Please order PDI-267 and specify the Nylon Spacer size. Note: "L" indicates standard sized spacer.

500 Series Arm (Example 508)

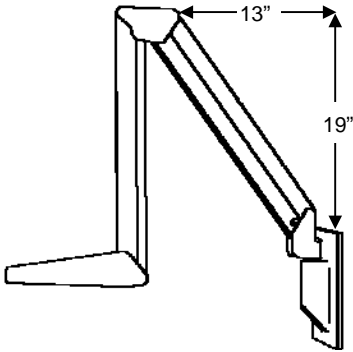

PDI-267 W/104 L

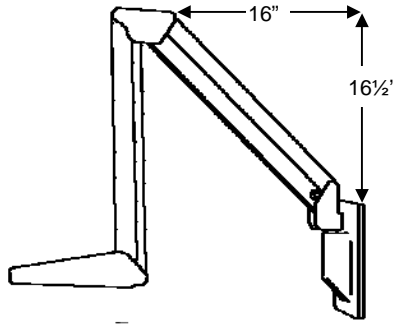

PDI-267 W/104 3/4"

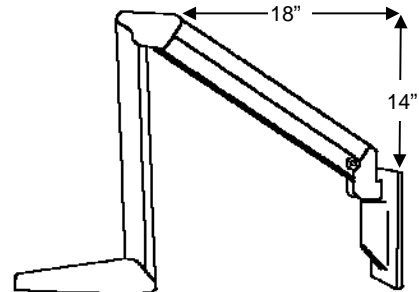

PDI-267 W/104 1"

405 Series Arm

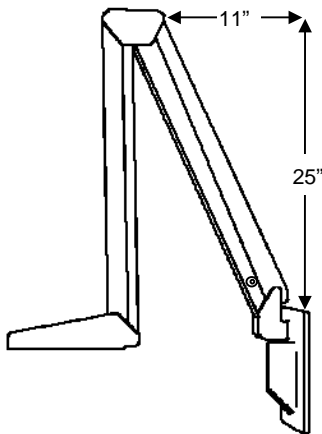

PDI-267 W/104 L

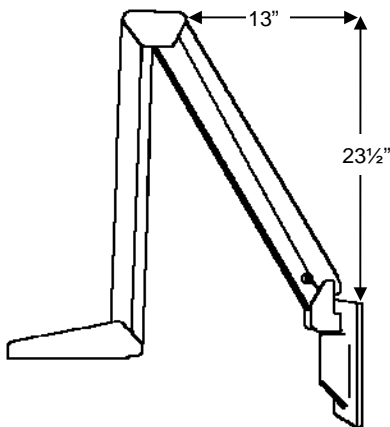

PDI-267 W/104 3/4"

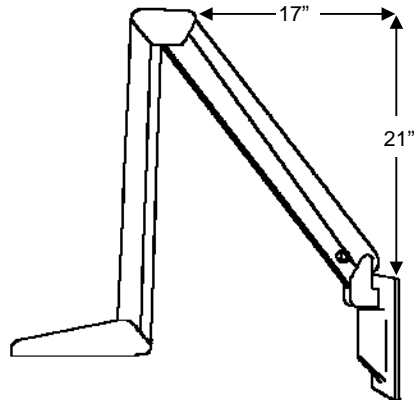

PDI-267 W/104 1"